

# Order Form/Design Configuration for the Positioning Systems Frame "Adacta Leo"

Order ☐ Quotation ☐





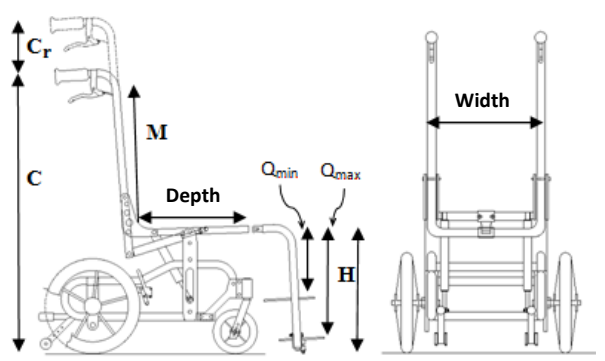

Invoicing Details	Shipping Details
Company name: _____ Delivery date required: ____ / ____ / ____ Delivery address: _____ P. Code.: _____ Town: _____ Tel.: _____ Fax: _____ # Order: _____ Date of the Order: ____ / ____ / ____	Ship to: _____ _____ <b>CUSTOMER STAMP AND SIGNATURE</b>

**Pro Medicare srl** grants **24 months** warranty on production defects from the date of the first put into service and **12 months** on covers and components subjected to wearing. Warranty is void if the product is used in any other way than stated in the Instruction Manual.

**Note:** Any request for variation in dimensions, materials and type compared to the standard does not have **CE** marking, therefore the professional user becomes the manufacturer and has the obligation to draw up the technical documentation of the device (this is valid for the sections of the sheet with the letter **W**; the prices of the **W** items are not present on this order form)

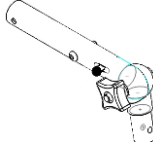
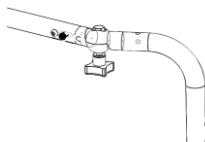
Images are purely illustrative and may not fully reflect reality.

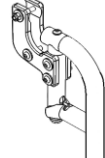
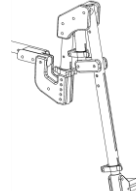
Standard Configuration																																										
<ul style="list-style-type: none"> <li>- Rigid satin anodised frame without sling</li> <li>- Folding down back posts with height adjustable and rotating pushing handles</li> <li>- Continuous Tilt in space by drive lever*:                Sizes US-XS from 2° to 30° (from 6° up to 34°)<sup>1</sup>                Sizes XS1-M1 from 4° to 30° (from 8° up to 34°)<sup>1</sup> </li> <li><sup>1</sup>tilt in space can be up-graded of 4° with an increment of the starting inclination of the frame by operating on the positioning holes of the casters forks</li> <li>- Continuous reclining by gas spring (from 3° up to 25°)</li> <li>- Continuous displacement of the upper frame with respect to under frame</li> <li>- Continuous displacement of the rear wheels plates</li> <li>- Fixed anti-tip system</li> <li>- Wheels Kit with brake</li> <li>- Knee Angle</li> <li>- Foot Plates</li> </ul>																																										
*guaranteed by operating first on the reclining and then on the tilt in space																																										
<b>Frame color</b> <input type="radio"/> Blue <input type="radio"/> Red <input type="radio"/> Turquoise <input type="radio"/> Pink <input type="radio"/> Titanium																																										
<b>Frame size</b> (Width measurements are from tube to tube externally, while depth measurements are from back post to footboard engagement)																																										
	Seat Width (cm)	Depth and Adjustments (cm)																																								
<b>Paediatric</b>	<input type="radio"/> US	30	38																																							
	<input type="radio"/> XXS	35	38																																							
	<input type="radio"/> XS	35	42																																							
<b>Adult</b>	<input type="radio"/> XS1	38	46																																							
	<input type="radio"/> S	41	46																																							
	<input type="radio"/> M	41	50																																							
	<input type="radio"/> M1	44	50																																							
																																										
<b>Choice of the Height</b> <table border="1"> <thead> <tr> <th></th> <th>Q (cm)</th> <th>H (cm)</th> </tr> </thead> <tbody> <tr> <td rowspan="4">Height with 300mm or 500mm wheels and 150mm or 175mm casters</td> <td>US-XXS</td> <td>13-23</td> </tr> <tr> <td>XS</td> <td>13-26</td> </tr> <tr> <td>XS1</td> <td>24-34</td> </tr> <tr> <td>S</td> <td>26-36</td> </tr> <tr> <td></td> <td>M-M1</td> <td>30-40</td> </tr> <tr> <td rowspan="4">Height with 400mm wheels</td> <td>US-XXS</td> <td>13-23</td> </tr> <tr> <td>XS</td> <td>13-26</td> </tr> <tr> <td>XS1</td> <td>24-34</td> </tr> <tr> <td>S</td> <td>26-36</td> </tr> <tr> <td></td> <td>M-M1</td> <td>30-40</td> </tr> <tr> <td rowspan="4">Height with 600mm wheels</td> <td>US-XXS</td> <td>13-23</td> </tr> <tr> <td>XS</td> <td>13-26</td> </tr> <tr> <td>XS1</td> <td>24-34</td> </tr> <tr> <td>S</td> <td>26-36</td> </tr> <tr> <td></td> <td>M-M1</td> <td>30-40</td> </tr> </tbody> </table>					Q (cm)	H (cm)	Height with 300mm or 500mm wheels and 150mm or 175mm casters	US-XXS	13-23	XS	13-26	XS1	24-34	S	26-36		M-M1	30-40	Height with 400mm wheels	US-XXS	13-23	XS	13-26	XS1	24-34	S	26-36		M-M1	30-40	Height with 600mm wheels	US-XXS	13-23	XS	13-26	XS1	24-34	S	26-36		M-M1	30-40
	Q (cm)	H (cm)																																								
Height with 300mm or 500mm wheels and 150mm or 175mm casters	US-XXS	13-23																																								
	XS	13-26																																								
	XS1	24-34																																								
	S	26-36																																								
	M-M1	30-40																																								
Height with 400mm wheels	US-XXS	13-23																																								
	XS	13-26																																								
	XS1	24-34																																								
	S	26-36																																								
	M-M1	30-40																																								
Height with 600mm wheels	US-XXS	13-23																																								
	XS	13-26																																								
	XS1	24-34																																								
	S	26-36																																								
	M-M1	30-40																																								
<b>Note:</b> with 600mm wheels the tilt in space and the reclining reduce to 20° <b>H:</b> height (distance from the seat rails to pavement detected from its middle point); <b>Q</b> (min-max): indicates the minimum/maximum distance of the footplate to the seat rails detected with 90° hanger and it can be increased of 5-7cm with 75° hanger or knee elevating tube; <b>C:</b> distance of the pushing handles to pavement: 110cm in the minimum position; <b>Cr:</b> telescopic push handles course: 12cm; <b>M:</b> backrest tube height from seat rails, useful for the positioning of the backrest.																																										
<b>Notes:</b> If a selection is not made, the product will be delivered in its standard configuration. (See <b>bold</b> items) <b>◇ = Standard</b> <input type="radio"/> = Optional without up-charge <input type="checkbox"/> = Optional with up-charge																																										

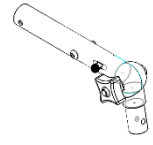
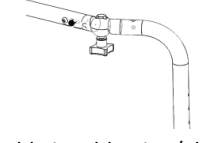
FRAME OPTIONS				
Castors				
<input checked="" type="radio"/> 150mm (6") poly grey <input type="radio"/> black		175mm (7") poly <input type="radio"/> grey <input type="radio"/> black		
Posterior Wheels				
<input checked="" type="radio"/> 300mm (12") poly grey with parking brake lever				
<input type="radio"/> 300mm (12") poly black with parking brake lever				
<input type="radio"/> 300mm (12") pneumatic grey with parking brake lever				
<input type="checkbox"/> 300mm (12") poly black with drum brake				
<input type="checkbox"/> 300mm (12") poly grey with drum brake				
<input type="checkbox"/> 300mm (12") pneumatic grey with drum brake				
<input type="checkbox"/> 300mm (12") poly black with drum brake and parking brake lever				
<input type="checkbox"/> 300mm (12") poly grey with drum brake and parking brake lever				
<input type="checkbox"/> 300mm (12") pneumatic grey with drum brake and parking brake lever				
<input type="checkbox"/> 400mm (16") poly black with parking brake lever (only 45 cm height)				
<input type="checkbox"/> 400mm (16") poly black with drum brake (only 45 cm height)				
<input type="checkbox"/> 400mm (16") poly black with drum brake and parking brake lever (only 45 cm height)				
<input type="checkbox"/> 500mm (20") poly grey without handrims with parking brake lever			<input type="checkbox"/> handrims for 500mm (20") wheels	
<input type="checkbox"/> 500mm (20") pneumatic grey without handrims with parking brake lever				
<input type="checkbox"/> 500mm (20") pneumatic grey with handrims with drum brake				
<input type="checkbox"/> 500mm (20") pneumatic grey with handrims with drum brake and parking brake lever				
<input type="checkbox"/> 600mm (24") pneumatic grey with handrims with parking brake lever (not available on size US)				
(NOTE. The tilt in space is reduced to 20°, only 47 cm height)				
Knee Angle				
Paediatric sizes US-XS (detachable only)				
	Angle 90° <input checked="" type="radio"/> RH <input checked="" type="radio"/> LH	Angle 75° <input type="radio"/> RH <input type="radio"/> LH	Elevating (with teathed mechanism) from 80° up to 180° with gap of 14° <input type="checkbox"/> RH <input type="checkbox"/> LH	Adjustable in adduction/abduction with tube RH -> <input type="checkbox"/> 75° <input type="checkbox"/> 90° LH -> <input type="checkbox"/> 75° <input type="checkbox"/> 90°
Adult sizes XS1-M1 (swing-away and detachable)				
	Angle 75° <input checked="" type="radio"/> RH <input checked="" type="radio"/> LH		Angle 90° <input type="radio"/> RH <input type="radio"/> LH	Vertical elevating and telescopic <input type="checkbox"/> RH <input type="checkbox"/> LH
Adult sizes XS1-M1 (detachable)				
	Angle 90° <input type="radio"/> RH <input type="radio"/> LH	Angle 75° <input type="radio"/> RH <input type="radio"/> LH	Elevating (with teathed mechanism) from 80° up to 180° with gap of 14° <input type="checkbox"/> RH <input type="checkbox"/> LH	Adjustable in adduction/abduction with tube RH -> <input type="checkbox"/> 75° <input type="checkbox"/> 90° LH -> <input type="checkbox"/> 75° <input type="checkbox"/> 90°
Note: the two types of knee angle mechanism of the Adult sizes (detachable, swing-away and detachable) are not after-sale interchangeable				
Footrest (with heel strap)				
<input checked="" type="radio"/> footplates <input type="radio"/> footboard				
<input type="checkbox"/> slotted (footplates only for intra-extra rotation of 15°) <input type="checkbox"/> RH <input type="checkbox"/> LH				
<input type="checkbox"/> multi-axial (on footplates only) <input type="checkbox"/> RH <input type="checkbox"/> LH    Additional kit of multi-axial mechanism				
Padding and cover in leatherette <input type="checkbox"/> divided <input type="checkbox"/> one piece				

◆ *Telescopic and rotating push handle kit*

- ## Tilt in space

- ### Anti-tip system

- ## FRAME ACCESSORIES

**Seat Base** **Note:** The wooden seat bases present posterior notches of 6 cm for an easy movement on the seat rails

- Abductor wedge** *only with rigid seat base*

### Abductor wedge

*only with rigid seat base*

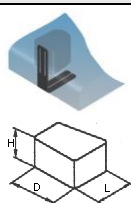

Size (cm)	<input type="checkbox"/> S	<input type="checkbox"/> M	<input type="checkbox"/> L	<input type="checkbox"/> W
H	7.5	9	10	
D	9	10	11.5	
L	7.5	9	10	

- ☐
- removable with lever



- ☐ removable mounting block



**Note:** if not indicate the abductor wedge will be removable with lever

**Please indicate the position of holes under the seat**  
(if not indicated the abductor wedge will be fixed in the standard position)

- ☐ standard
- ☐ on the RH
- ☐ on the LH
- ☐ not centred

### Backrest base

- ☐ wooden backrest base covered in black leatherette *(with male and female hook and loop fastening straps)*
- ☐ wooden backrest base with mounting kit *(assembly of the various threaded inserts and clamps must be performed by the customer)*
- ☐ tensioning strap system *(with fastening straps)*

**Wooden Supporting Base for Breathing Equipment covered in black leatherette** *(available with tilt in space with lever only)*

**Note:** Bulky equipments may lead to a reduction of the tilt in space /reclining values

- ☐ with maximum breathing equipment dimensions of: Width: 25cm; Length: 30cm; Height: 10cm
- ☐ with maximum breathing equipment dimensions exceeding 25x30x10cm

In this situation, please indicate: Width : Length : Height : NOTE

**Note:** Pro Medicare Srl reserves the right to check wheelchair compatibility

## Pedal for barriers

side ☐ RH ☐ LH

## Leg Support

**Separate Leg Cradle** (adjustable in height and depth) ☐ RH ☐ LH ☐ custom W

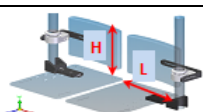

cm	US	XXS	XS	XS1	S	M	M1	W <sub>RH</sub>	W <sub>LH</sub>
H	10	12.5	12.5	15	15	18	18	.....	.....
L	9.5	12.5	12.5	12.5	14	14	15.5	.....	.....

- ☐ **Calf Panel** (*adjustable in height and depth*)

- ☐
- custom
- W**

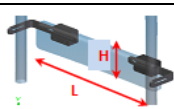

cm	US	XXS	XS	XS1	S	M	M1	W
H	10	12	12	15	18	18	18	.....
L	23	26.5	26.5	25	28	28	31	.....

- ☐
- Padded Calf Strap**

- ☐
- custom W

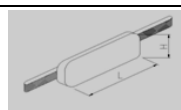

cm	US	XXS	XS	XS1	S	M	M1	W
H	11	11	11	11	13	13	13	.....
L	26	31	31	34	37	37	40	

- ☐ **Simple Calf Strap** *Height 4 cm*

**Padded Divided Leg Cradles** (adjustable in height and depth) ☐ RH ☐ LH

- ☐
- custom W

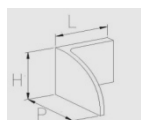

cm	US	XXS	XS	XS1	S	M	M1	W <sub>LH</sub>	W <sub>LH</sub>
H	12.5	15	15	17.5	17.5	20	20	.....	.....
L	12.5	14	14	15.5	17	17	19	.....	.....
P	13.5	14	14	15	15	15.5	15.5	.....	.....

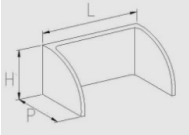
<input type="checkbox"/> <b>Padded foot box</b> (adjustable in height and depth)								<input type="checkbox"/> custom <b>W</b>	
	cm	<b>US</b>	<b>XXS</b>	<b>XS</b>	<b>XS1</b>	<b>S</b>	<b>M</b>	<b>M1</b>	<b>W</b>
	<b>H</b>	12.5	15	15	17.5	17.5	20	20	.....
	<b>L</b>	23.5	29	29	32.5	35.5	35.5	38.5	.....
	<b>P</b>	13.5	14	14	15	15	15	15.5	.....
<b>Cover for Knee Angle joint</b> <input type="checkbox"/> RH <input type="checkbox"/> LH					<b>Cover for legrest tube</b> <input type="checkbox"/> RH <input type="checkbox"/> LH				

## Armrest

### ☐ Height adjustable flip back tubular armrests/inclination max 5°

- ☐ small (L = 25 cm)
- ☐ large (L = 30 cm)

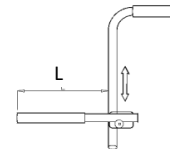

### ☐ Kit of ABS laterals multi-adjustable, detachable and w/multi-adjustable arm support in width and depth with a gap of 2.5 cm

make a selection:

- ☐ small arm support (from US to XS0)  
(dimensions: 5 cm x 25 cm)
- ☐ large arm support (from XS1 to XL)  
(dimensions: 6 cm x 30 cm)

make a selection:

- ☐ short vertical bar (from 22 cm to 31 cm\*)
- ☐ long vertical bar (from 29 cm to 38 cm\*)
- \* distance from armrest to the seat rail

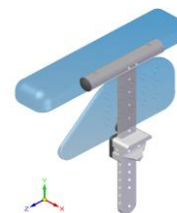

### ☐ Kit of hardware multi-adjustable, detachable for ABS laterals

make a selection:

- ☐ short vertical bar (from 19 cm to 28 cm\*)
- ☐ long vertical bar (from 26 cm to 35 cm\*)
- \* distance from hardware to the seat rail

make a selection:

- ☐ hip guide pad ① see below
- ☐ arm support pad ② see below

ABS Lateral: ☐ RH   ☐ LH



**Padding for ABS Laterals**   ☐ RH   ☐ LH

**Spacer for ABS laterals**   ☐ 1 cm   ☐ 1.5 cm   ☐ 2 cm   ☐ RH   ☐ LH

## Hip Guides

### ☐ Linear Hip Guide ① (pad only)

### ☐ Linear Hip Guide pad w/mounting bracket

	cm	<b>XS</b>	<b>S</b>	<b>M</b>	<b>L</b>	<b>W<sub>RH</sub></b>	<b>W<sub>LH</sub></b>
<b>H</b>		8	10	10	12	.....	.....
<b>L</b>		22	25	30	35	.....	.....

Side	Pad size	Select the bracket*	Select the bracket shape*
<input type="checkbox"/> RH		<input type="checkbox"/> Fixed <input type="checkbox"/> Detachable	<input type="checkbox"/> A <input type="checkbox"/> B <input type="checkbox"/> C <input type="checkbox"/> D
<input type="checkbox"/> LH		<input type="checkbox"/> Fixed <input type="checkbox"/> Detachable	<input type="checkbox"/> A <input type="checkbox"/> B <input type="checkbox"/> C <input type="checkbox"/> D

Bracket Padding:   ☐ RH   ☐ LH

### ☐ Contoured Hip Guide ① (pad only)

### ☐ Contoured Hip Guide pad w/mounting bracket

	cm	<b>XS</b>	<b>S</b>	<b>M</b>	<b>L</b>	<b>W<sub>RH</sub></b>	<b>W<sub>LH</sub></b>
<b>H</b>		8	10	10	12	.....	.....
<b>L</b>		22	25	30	35	.....	.....

Side	Pad size	Select the bracket*	Select the bracket shape*
<input type="checkbox"/> RH		<input type="checkbox"/> Fixed <input type="checkbox"/> Detachable	<input type="checkbox"/> A <input type="checkbox"/> B <input type="checkbox"/> C <input type="checkbox"/> D
<input type="checkbox"/> LH		<input type="checkbox"/> Fixed <input type="checkbox"/> Detachable	<input type="checkbox"/> A <input type="checkbox"/> B <input type="checkbox"/> C <input type="checkbox"/> D

Bracket Padding:   ☐ RH   ☐ LH

**Note:** If the bracket feature is not selected the fixed bracket will be delivered; for the choice of bracket shape see below

**\*Brackets** (They allow adjustments of the seat and/or backrest width)

### Shape

- A** L/90° Bracket allows a reduction of the width up to 2.5 cm per side
- B** 2.5 cm Offset Bracket allows a reduction of the width up to 5 cm per side
- C** 5 cm Offset Brackets allows a reduction of the width up to 7.5 cm per side
- D** Reverse Bracket doesn't allow any variation of the width



**A**

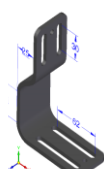

**B**

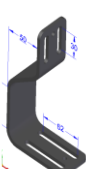

**C**

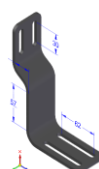

**D**

### Type





Fixed Bracket

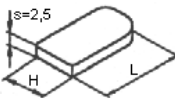
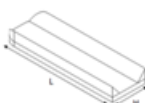
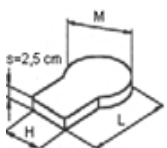
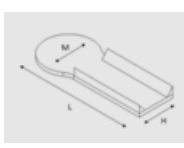

Detachable Bracket

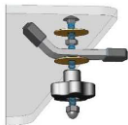
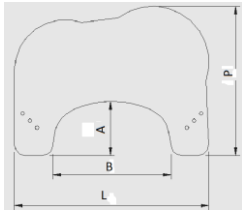
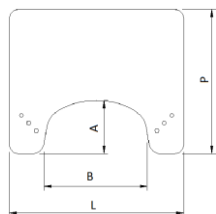
Arm Supports																	
<input type="checkbox"/> Flat Arm Support ② (pad only)							<input type="checkbox"/> Inside/outside flat Contoured Arm Support ② (pad only)										
<input type="checkbox"/> Flat arm support w/brackets							<input type="checkbox"/> Inside/outside flat Contoured arm support w/brackets										
		cm	XS	S	M	L	W <sub>RH</sub>	W <sub>LH</sub>			cm	XS	S	M	L	W <sub>RH</sub>	W <sub>LH</sub>
H			8	10	10	12	.....	.....	H			8	10	10	12	.....	.....
L			22	25	30	35	.....	.....	L			22	25	30	35	.....	.....
Side	Size																
<input type="checkbox"/> RH																	
<input type="checkbox"/> LH																	
<input type="checkbox"/> Flat and Shaped Arm Support ② (pad only)							<input type="checkbox"/> Inside/outside Contoured and Shaped Arm Supports ② (pad only)										
<input type="checkbox"/> Flat and Shaped Arm Support w/brackets							<input type="checkbox"/> Inside/outside Contoured and Shaped Arm Supports w/brackets										
		cm	XS	S	M	L	W <sub>dx</sub>	W <sub>sx</sub>			cm	XS	S	M	L	W <sub>dx</sub>	W <sub>sx</sub>
H			8	10	10	12	.....	.....	H			8	10	10	12	.....	.....
L			30	35	40	48	.....	.....	L			30	35	40	48	.....	.....
M			12	15	17	17	.....	.....	M			12	15	17	17	.....	.....
Side	Type of Shape		Size														
<input type="checkbox"/> RH	<input type="radio"/> palmar <input type="radio"/> elbow																
<input type="checkbox"/> RH	<input type="radio"/> palmar <input type="radio"/> elbow																

Wooden Tray					
<input type="checkbox"/> Ergonomic		with Hardware <input type="checkbox"/> w/lateral flip <input type="checkbox"/> detachable		Type of hardware	
<input type="checkbox"/> Rectangular		with Hardware <input type="checkbox"/> w/lateral flip <input type="checkbox"/> detachable		 lateral flip  detachable	
<b>Padding</b> <input type="checkbox"/> in black leatherette <input type="checkbox"/> in blue leatherette					
<input type="checkbox"/> Outer Edge					
ergonomic tray dimensions				rectangular tray dimensions	
	Size cm	<input type="checkbox"/> US	<input type="checkbox"/> P	<input type="checkbox"/> M	<input type="checkbox"/> G
	P	47	53	58	66
	L	58	69	75	86
	B	35	42	49	55
	A	17	19	21	24
	Size cm	<input type="checkbox"/> US	<input type="checkbox"/> P	<input type="checkbox"/> M	<input type="checkbox"/> G
	P	45	50	55	63
	L	56	66	71	82
	B	35	42	48	55
	A	17	19	21	24

Pelvic Belt (w/2 adjustments Versa-Fixatis) (for other models please see Fixatis Range order form)					
 Plastic buckle closure	cm	<input type="checkbox"/> XS	<input type="checkbox"/> S	<input type="checkbox"/> M	<input type="checkbox"/> L
	H (pad height)	4.5	5.5	7	7
	L (pad length)	12	17	22	27

FRAME DIMENSIONS AND FEATURES									
Size	US	XXS	XS	XS1	S	M	M1		
Load (kg)	50	50	50	75	75	100	100		
Frame Weight* (kg)	15.5	15.7	16.1	19.8	20.4	21	21.7		
*Weight of the frame, including knee angle and footplates as per standard configuration									
Overall dimensions (cm) of the frame with backrest tubes (fixed) folded down, footrest and posterior wheels detached									
Size	US	XXS	XS	XS1	S	M	M1		
Length	66	66	68	71	73	83	83		
Width	42	48	48	51	54	54	57		
Height	65	65	66	67	67	68	68		
Weight (kg)	11.5	11.7	12.1	14.5	15.1	15.7	16.7		
<b>Note:</b> The length dimensions, referred to the average values, are subjected to the variations due to the displacement of the wheel plates. The values reported are intended for the standard configuration.									
Width (cm)									
Size		US	XXS	XS	XS1	S	M	M1	
300mm wheel	standard	48	53	53	56	59	59	62	
	w/drum brake	49	54	54	57	60	60	63	
400/500mm wheel	standard	50	55	55	58	61	61	64	
	w/drum brake	53	58	58	61	64	64	67	
600mm wheel	/	/	55	55	58	61	61	64	
Pivot Width (cm)		69	69	72	75	75	78	78	
Q*(min-max) Height Seat rail to footplate (cm)		13-23	13-23	13-26	28-36	28-36	32-40	32-40	
H** Seat rail to floor (cm)		43-49 with 300mm/500mm wheels and 150mm/175mm casters 45 with 400mm wheels and 150/175mm casters 47 with 600mm wheels and 150mm casters							
Max Slope		7°							
<b>Note:</b> * The value Q , referred to 90° footrest hanger, can be increased of about 5-7 cm by using the 75° hanger ** The value H has been detected outside the seat tube at the plate of the tilt mechanism; the frame will be delivered with H=43 cm									
Length (cm)									
Size			US	XXS	XS	XS1	S	M	M1
300mm wheel	Without knee joint	L	70	70	73	75	75	78	78
	75° Knee Angle	L <sub>min</sub> /L <sub>max</sub>	92/99	92/99	93/100	97/104	97/104	100/107	100/107
	90° Knee Angle	L <sub>min</sub> /L <sub>max</sub>	88/94	88/96	91/99	93/100	93/100	96/103	96/103
400mm wheel	Without knee joint	L	74	74	77	79	79	82	82
	75° Knee Angle	L <sub>min</sub> /L <sub>max</sub>	95/101	95/101	96/103	100/107	100/107	103/110	103/110
	90° Knee Angle	L <sub>min</sub> /L <sub>max</sub>	93/99	93/99	94/100	96/102	96/102	99/104	99/104
500mm wheel	Without knee joint	L	78	78	81	84	84	87	87
	75° Knee Angle	L <sub>min</sub> /L <sub>max</sub>	98/103	98/103	99/107	103/113	103/113	106/116	106/116
	90° Knee Angle	L <sub>min</sub> /L <sub>max</sub>	95/101	95/101	97/102	100/106	100/106	103/109	103/109
600mm wheel	Without knee joint	L	/	83	84	85	85	88	88
	75° Knee Angle	L <sub>min</sub> /L <sub>max</sub>	/	101/109	103/112	108/116	108/116	111/120	111/120
	90° Knee Angle	L <sub>min</sub> /L <sub>max</sub>	/	98/104	101/107	105/112	105/112	108/116	108/116
L = Length of the frame without knee angle joint mechanism; L <sub>min</sub> = Length of the frame with knee angle joint mechanism and footplate positioned backward; L <sub>max</sub> = Length of the frame with knee angle joint mechanism and footplate positioned forward. <b>Note:</b> The length dimensions, referred to the average values, are subjected to variations due to the displacement of the wheel plates. The values reported are intended for the standard configuration									

## Note



**PRO MEDICARE S.r.l.**  
Via Montagna Z.I. Lotto 41-72023 Mesagne (Br)-ITALY  
Tel: +39-0831-777840  
Website: [www.promedicare.eu](http://www.promedicare.eu) e-mail: [sales@promedicare.it](mailto:sales@promedicare.it)