

Order Form/Design Configuration for the Positioning Systems Frame Adacta Liga Light

Order ☐ Quotation ☐

| Invoicing Details | Shipping Details |
|--|-------------------------------------|
| Company name: _____ | Ship to: _____ |
| Delivery date required: ____ / ____ / ____ | _____ |
| Delivery address: _____ | CUSTOMER STAMP AND SIGNATURE |
| P. Code.: _____ Town: _____ | |
| Tel.: _____ Fax: _____ | |
| # Order: _____ Date of the Order: ____ / ____ / ____ | |

Pro Medicare srl grants **24 months** warranty on production defects from the date of the first put into service and **12 months** on covers and components subjected to wearing. Warranty is void if the product is used in any other way than stated in the Instruction Manual.

Note: Any request for variation in dimensions, materials and type compared to the standard does not have **CE** marking, therefore the professional user becomes the manufacturer and has the obligation to draw up the technical documentation of the device (this is valid for the sections of the sheet with the letter **W**; the prices of the **W** items are not present on this order form)

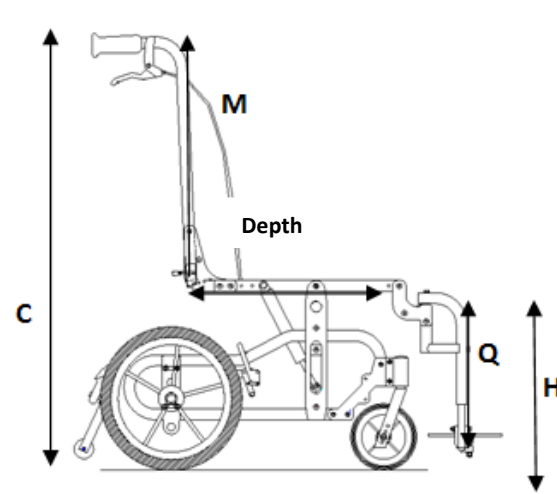
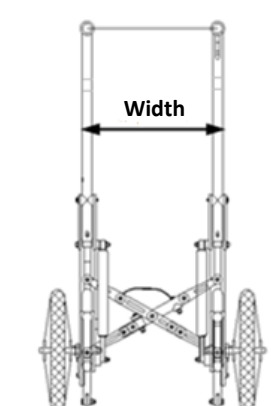

Images are purely illustrative and may not fully reflect reality.

| Standard Configuration | | | |
|--|---------------------------|---|--|
| <ul style="list-style-type: none"> - Adacta Liga satin anodised Frame - Fixed folding down back posts - Reclining mechanism by predetermined plate w/pin 3°, 9°, 15°, 22° - Continuous Tilt in space by drive lever: paediatric from 2° up to 35° (from 6° up to 39°)¹ adult from 4° up to 30° (from 8° up to 34°)¹ ¹ tilt in space can be up-graded of 4° with increment of the starting inclination of the frame by operating on the positioning holes of the casters forks - Fixed anti-tip system - Wheels Kit with brake - Adjustment of the seat depth - Height adjustment: high (49 cm from the floor)/low (43 cm from the floor)* *(with 300mm and 500mm wheels only) - Knee angle - Foot Plates - Simple Calf Strap | | | |
| Frame Type | | <input type="checkbox"/> Rigid <input type="checkbox"/> Folding | |
| Frame Color | | <input type="radio"/> Blue <input type="radio"/> Red <input type="radio"/> Turquoise <input type="radio"/> Pink <input type="radio"/> Titanium | |
| Frame Size (Width measurements are from tube to tube externally, while depth measurements are from back post to footboard engagement). | | | |
| | | Seat Width (cm) | Depth and Adjustment (cm) |
| Paediatric | <input type="radio"/> US | 30 | <input type="radio"/> 36 <input checked="" type="radio"/> 38.5 <input type="radio"/> 41 <input type="radio"/> 44 |
| | <input type="radio"/> XXS | 35 | <input type="radio"/> 36 <input checked="" type="radio"/> 38.5 <input type="radio"/> 41 <input type="radio"/> 44 |
| | <input type="radio"/> XS | 35 | <input type="radio"/> 40 <input checked="" type="radio"/> 42.5 <input type="radio"/> 45 <input type="radio"/> 48 |
| | <input type="radio"/> XS0 | 38 | <input type="radio"/> 40 <input checked="" type="radio"/> 42.5 <input type="radio"/> 45 <input type="radio"/> 48 |
| Adult | <input type="radio"/> XS1 | 38 | <input type="radio"/> 44 <input checked="" type="radio"/> 46.5 <input type="radio"/> 49 <input type="radio"/> 52 |
| | <input type="radio"/> S | 41 | <input type="radio"/> 44 <input checked="" type="radio"/> 46.5 <input type="radio"/> 49 <input type="radio"/> 52 |
| | <input type="radio"/> M | 41 | <input type="radio"/> 48 <input checked="" type="radio"/> 50.5 <input type="radio"/> 53 <input type="radio"/> 56 |
| | <input type="radio"/> M1 | 44 | <input type="radio"/> 48 <input checked="" type="radio"/> 50.5 <input type="radio"/> 53 <input type="radio"/> 56 |
| | <input type="radio"/> L | 47 | <input type="radio"/> 44 <input checked="" type="radio"/> 46.5 <input type="radio"/> 49 <input type="radio"/> 52 |
| | <input type="radio"/> XL | 47 | <input type="radio"/> 48 <input checked="" type="radio"/> 50.5 <input type="radio"/> 53 <input type="radio"/> 56 |

H: seat rails to floor height (see page 6)
Q: length from seat rails to footplate (see page 6)
C: push handles height to floor = 110 cm
M: push handles height from seat rails (see page 2)

Notes: If a selection is not made, the product will be delivered in its standard configuration. (See **bold** items)
☒ = **Standard** ☐ = Optional without up-charge
☐ = Optional with up-charge

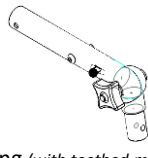
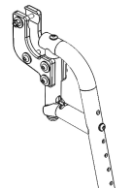
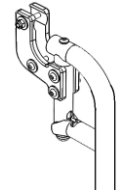
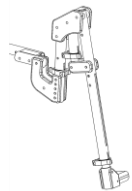

| FRAME OPTIONS | | | |
|--|--|--|--|
| Castors | | | |
| <input checked="" type="checkbox"/> 150mm (6") poly grey <input type="checkbox"/> black | | 175mm (7") poly <input type="checkbox"/> grey <input type="checkbox"/> black | |
| Posterior Wheels | | | |
| <input checked="" type="checkbox"/> 300mm (12") poly grey with parking brake lever <input type="checkbox"/> 300mm (12") poly black with parking brake lever <input type="checkbox"/> 300mm (12") pneumatic grey with parking brake lever | | | |
| <input type="checkbox"/> 300mm (12") poly black with drum brake <input type="checkbox"/> 300mm (12") poly grey with drum brake <input type="checkbox"/> 300mm (12") pneumatic grey with drum brake | | | |
| <input type="checkbox"/> 300mm (12") poly black with drum brake and parking brake lever <input type="checkbox"/> 300mm (12") poly grey with drum brake and parking brake lever <input type="checkbox"/> 300mm (12") pneumatic grey with drum brake and parking brake lever | | | |
| <input type="checkbox"/> 400mm (16") poly black with parking brake lever (only 45 cm height) | | | |
| <input type="checkbox"/> 400mm (16") poly black with drum brake (only 45 cm height) | | | |
| <input type="checkbox"/> 400mm (16") poly black with drum brake and parking brake lever (only 45 cm height) | | | |
| <input type="checkbox"/> 500mm (20") poly grey without handrims with parking brake lever <input type="checkbox"/> 500mm (20") pneumatic grey without handrims with parking brake lever | | <input type="checkbox"/> handrims for 500mm (20") wheels | |
| <input type="checkbox"/> 500mm (20") pneumatic grey with handrims with drum brake | | | |
| <input type="checkbox"/> 500mm (20") pneumatic grey with handrims with drum brake and parking brake lever | | | |
| <input type="checkbox"/> 600mm (24") pneumatic grey with handrims with parking brake lever (not available on size US) (NOTE. The tilt in space is reduced to 20°, only 47 cm height) | | | |
| Knee Angle | | | |
| Paediatric Sizes from US-XS0 (detachable) |  Angle 90° <input checked="" type="checkbox"/> RH <input checked="" type="checkbox"/> LH |  Angle 75° <input type="checkbox"/> RH <input type="checkbox"/> LH |  Elevating (with teathed mechanism) from 80° up to 180° with a gap of 14° <input type="checkbox"/> RH <input type="checkbox"/> LH |
| | | | |
| Adult Sizes from XS1-XL (swing-away and detachable) |  Angle 75° <input checked="" type="checkbox"/> RH <input checked="" type="checkbox"/> LH |  Angle 90° <input type="checkbox"/> RH <input type="checkbox"/> LH |  Vertical elevating and telescopic <input type="checkbox"/> RH <input type="checkbox"/> LH |
| | | | |
| Footrest | | | |
| <input checked="" type="checkbox"/> footplates <input type="checkbox"/> footboard <input type="checkbox"/> slotted (footplates only for intra-extra rotation of 15°) | | | |
| padding and cover in leatherette <input type="checkbox"/> divided <input type="checkbox"/> one piece | | | |
| Back Posts | | | |
| <input checked="" type="checkbox"/> Kit for fixed push handles <input type="checkbox"/> Kit for push handles adjustable in height by pin (max adjustment 10 cm with 2.5 cm gap) Note: height M push handles equal to 63 cm <input type="checkbox"/> Kit for telescopic push handles with lever block (max adjustment 10 cm) <input type="checkbox"/> Kit for angle adjustable single handlebar for rigid frame <input type="checkbox"/> Kit for angle adjustable separated handlebar for folding frame (only for paediatric frame sizes) <input type="checkbox"/> Kit for telescopic and angle adjustable single handlebar <input type="checkbox"/> Quick-release pins for easier backrest inclination (not valid for crash test) | | | |
| Tilt in space | | | |
| <input checked="" type="checkbox"/> with lever <input type="checkbox"/> with pedal | | | |
| Anti-tip system | | | |
| <input checked="" type="checkbox"/> fixed <input type="checkbox"/> detachable | | | |

FRAME ACCESSORIES

Seat Base Note: The wooden seat bases present posterior notches of 6 cm for an easy movement on the seat rails

- ☐ wooden seat base covered in black leatherette (with male and female hook and loop fastening straps)
- ☐ wooden seat base with mounting kit (assembly of the various threaded inserts and clamps must be performed by the customer)
- ☐ fixed grey wooden seat base with slots

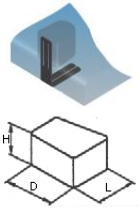
Abductor wedge only with rigid seat base

| | | | | | | | |
|---|------------------|----------------------------|----------------------------|----------------------------|----------------------------|--|---|
|  | Size (cm) | <input type="checkbox"/> S | <input type="checkbox"/> M | <input type="checkbox"/> L | <input type="checkbox"/> W | <input type="checkbox"/> removable with lever  | <input type="checkbox"/> removable mounting block  |
| | H | 7.5 | 9 | 10 | | | |
| | D | 9 | 10 | 11.5 | | Note: if not indicate the abductor wedge will be removable with lever | |
| | L | 7.5 | 9 | 10 | | Please indicate the position of holes under the seat <input type="checkbox"/> standard (if not indicated the abductor wedge will be fixed in the standard position) <input type="checkbox"/> on the RH <input type="checkbox"/> on the LH | |

Vehicle Transportation Kit (according to the ISO 7176-19 standard)

Do not use the wheelchair as a seat in a vehicle if the weight of the user is lower than 22 kg

- ☐ only frame height 43 cm and with 300mm (12") and 500mm (20") posterior wheels (it is strongly recommended the use of a headrest)

Wooden Supporting Base for Breathing Equipment covered in black leatherette (available with tilt in space with lever only)

Note: Bulky equipments may lead to a reduction of the tilt in space /reclining values

- ☐ with maximum breathing equipment dimensions of: Width: 25cm; Length: 30cm; Height: 10cm
- ☐ with maximum breathing equipment dimensions exceeding 25x30x10cm

In this situation, please indicate: Width _____; Length _____; Height _____; NOTE _____

Note: Pro Medicare Srl reserves the right to check wheelchair compatibility

Pedal for barriers

Side ☐ RH ☐ LH

Leg Support

Separate Leg Cradle (adjustable in height and depth) ☐ RH ☐ LH ☐ custom W

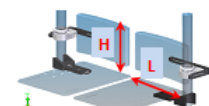
|  | cm | US | XXS | XS | XS0 | XS1 | S | M | M1 | L | XL | W _{RH} | W _{LH} | |
|---|----------|-----|------|------|------|------|------|----|----|------|------|-----------------|-----------------|-------|
| | H | 10 | 12,5 | 12,5 | 15 | 15 | 15 | 18 | 18 | 18 | 18 | | | |
| | L | 9.5 | 12.5 | 12.5 | 12.5 | 12.5 | 12.5 | 14 | 14 | 15.5 | 17.5 | 17.5 | | |
| | | | | | | | | | | | | | | |

☐ **Calf Panel** (adjustable in height and depth) ☐ custom W

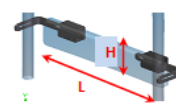
|  | cm | US | XXS | XS | XS0 | XS1 | S | M | M1 | L | XL | W |
|---|----------|----|------|------|-----|-----|----|----|----|----|----|-------|
| | H | 10 | 12 | 12 | 15 | 15 | 18 | 18 | 18 | 18 | 18 | |
| | L | 23 | 26,5 | 26,5 | 25 | 25 | 28 | 28 | 31 | 34 | 34 | |
| | | | | | | | | | | | | |

☐ **Padded Calf Strap** ☐ custom W

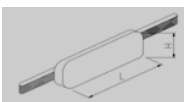
|  | cm | US | XXS | XS | XS0 | XS1 | S | M | M1 | L | XL | W |
|---|----------|----|-----|----|-----|-----|----|----|----|----|----|-------|
| | H | 11 | 11 | 11 | 11 | 11 | 13 | 13 | 13 | 13 | 13 | |
| | L | 26 | 31 | 31 | 34 | 34 | 37 | 37 | 40 | 43 | 43 | |
| | | | | | | | | | | | | |

Padded Divided Leg Cradles (adjustable in height and depth) ☐ RH ☐ LH ☐ custom W

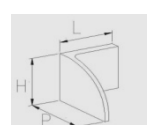
|  | cm | US | XXS | XS | XS0 | XS1 | S | M | M1 | L | XL | W _{RH} | W _{LH} |
|---|----------|------|-----|----|------|------|------|------|------|------|------|-----------------|-----------------|
| | H | 12.5 | 15 | 15 | 17.5 | 17.5 | 17.5 | 20 | 20 | 20 | 20 | | |
| | L | 12.5 | 14 | 14 | 15.5 | 15.5 | 17 | 17 | 19 | 22.5 | 22.5 | | |
| | P | 13.5 | 14 | 14 | 15 | 15 | 15 | 15.5 | 15.5 | 16 | 16 | | |
| | | | | | | | | | | | | | |

☐ **Padded foot box** (adjustable in height and depth) ☐ custom W

|  | cm | US | XXS | XS | XS0 | XS1 | S | M | M1 | L | XL | W |
|---|----------|------|-----|----|------|------|------|------|------|------|------|-------|
| | H | 12.5 | 15 | 15 | 17.5 | 17.5 | 17.5 | 20 | 20 | 22.5 | 22.5 | |
| | L | 23.5 | 29 | 29 | 32.5 | 32.5 | 35.5 | 35.5 | 38.5 | 41.5 | 41.5 | |
| | P | 13.5 | 14 | 14 | 15 | 15 | 15 | 15 | 15.5 | 16 | 16 | |

Cover for Knee Angle joint ☐ RH ☐ LH

Cover for legrest tube ☐ RH ☐ LH

Armrest

☐ Height adjustable flip back tubular armrests/inclination max 5°

- small (L = 25 cm)
- large (L = 30 cm)

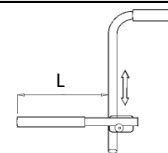

☐ Kit of ABS laterals multi-adjustable, detachable and w/multi-adjustable arm support in width and depth with 2.5 cm gap

make a selection:

- small arm support (from US to XS0)
(dimensions: 5 cm x 25 cm)
- large arm support (from XS1 to XL)
(dimensions: 6 cm x 30 cm)

make a selection:

- short vertical bar (from 22 cm to 31 cm*)
- long vertical bar (from 29 cm to 38 cm*)
- * distance from armrest to the seat rail

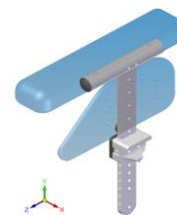

☐ Kit of hardware multi-adjustable, detachable for ABS laterals

make a selection:

- short vertical bar (from 19 cm to 28 cm*)
- long vertical bar (from 26 cm to 35 cm*)
- *distance from hardware to the seat rail

make a selection:

- hip guide pad ① see below
- arm support pad ② see below

ABS Lateral: ☐ RH ☐ LH



Padding for ABS Laterals ☐ RH ☐ LH

Spacer for ABS laterals ☐ 1 cm ☐ 1.5 cm ☐ 2 cm ☐ RH ☐ LH

Hip Guides

☐ Linear Hip Guide ① (pad only)

☐ Linear Hip Guide pad w/mounting bracket

| | cm | XS | S | M | L | W _{RH} | W _{LH} |
|---|----|----|----|----|-------|-----------------|-----------------|
| H | 8 | 10 | 10 | 12 | | | |
| L | 22 | 25 | 30 | 35 | | | |

| Side | Pad size | Select the bracket* | Select the bracket shape* |
|-----------------------------|----------|---|--|
| <input type="checkbox"/> RH | | <input type="checkbox"/> Fixed <input type="checkbox"/> Detachable | <input type="checkbox"/> A <input type="checkbox"/> B <input type="checkbox"/> C <input type="checkbox"/> D |
| <input type="checkbox"/> LH | | <input type="checkbox"/> Fixed <input type="checkbox"/> Detachable | <input type="checkbox"/> A <input type="checkbox"/> B <input type="checkbox"/> C <input type="checkbox"/> D |

Bracket Padding: ☐ RH ☐ LH

☐ Contoured Hip Guide ① (pad only)

☐ Contoured Hip Guide pad w/mounting bracket

| | cm | XS | S | M | L | W _{RH} | W _{LH} |
|---|----|----|----|----|-------|-----------------|-----------------|
| H | 8 | 10 | 10 | 12 | | | |
| L | 22 | 25 | 30 | 35 | | | |

| Side | Pad size | Select the bracket* | Select the bracket shape* |
|-----------------------------|----------|---|--|
| <input type="checkbox"/> RH | | <input type="checkbox"/> Fixed <input type="checkbox"/> Detachable | <input type="checkbox"/> A <input type="checkbox"/> B <input type="checkbox"/> C <input type="checkbox"/> D |
| <input type="checkbox"/> LH | | <input type="checkbox"/> Fixed <input type="checkbox"/> Detachable | <input type="checkbox"/> A <input type="checkbox"/> B <input type="checkbox"/> C <input type="checkbox"/> D |

Bracket Padding: ☐ RH ☐ LH

Note: If the bracket feature is not selected the fixed bracket will be delivered; for the choice of bracket shape see below

***Brackets** (They allow adjustments of the seat and/or backrest width)

Shape

- A** L/90° Bracket allows a reduction of the width up to 2.5 cm per side
- B** 2.5 cm Offset Bracket allows a reduction of the width up to 5 cm per side
- C** 5 cm Offset Brackets allows a reduction of the width up to 7.5 cm per side
- D** Reverse Bracket doesn't allow any variation of the width



A

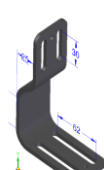

B

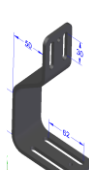

C

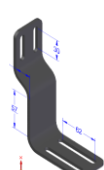

D



Type





Fixed Bracket

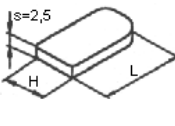

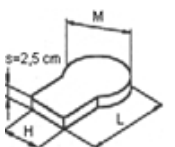
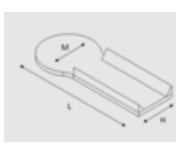
Detachable Bracket

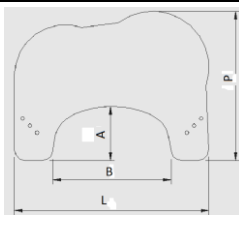
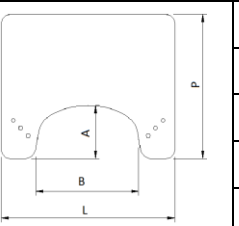
| Arm Supports | | | | | | | | | | | | | | | | | |
|---|--|---|----|----|------|----|-----------------|--|---|---|----|----|------|----|----|-----------------|-----------------|
| <input type="checkbox"/> Flat Arm Support ② (<i>pad only</i>) | | | | | | | | <input type="checkbox"/> Inside/outside flat Contoured Arm Support ② (<i>pad only</i>) | | | | | | | | | |
| <input type="checkbox"/> Flat arm support w/brackets | | | | | | | | <input type="checkbox"/> Inside/outside flat Contoured arm support w/brackets | | | | | | | | | |
|  | | cm | XS | S | M | L | W _{RH} | W _{LH} |  | | cm | XS | S | M | L | W _{RH} | W _{LH} |
| | | H | 8 | 10 | 10 | 12 | | | | | H | 8 | 10 | 10 | 12 | | |
| | | L | 22 | 25 | 30 | 35 | | | | | L | 22 | 25 | 30 | 35 | | |
| Side | | Size | | | | | | Side | | Size | | | | | | | |
| <input type="checkbox"/> RH | | | | | | | | <input type="checkbox"/> RH | | | | | | | | | |
| <input type="checkbox"/> LH | | | | | | | | <input type="checkbox"/> LH | | | | | | | | | |
| <input type="checkbox"/> Flat and Shaped Arm Support ② (<i>pad only</i>) | | | | | | | | <input type="checkbox"/> Inside/outside Contoured and Shaped Arm Supports ② (<i>pad only</i>) | | | | | | | | | |
| <input type="checkbox"/> Flat and Shaped Arm Support w/brackets | | | | | | | | <input type="checkbox"/> Inside/outside Contoured and Shaped Arm Supports w/brackets | | | | | | | | | |
|  | | cm | XS | S | M | L | W _{RH} | W _{LH} |  | | cm | XS | S | M | L | W _{RH} | W _{LH} |
| | | H | 8 | 10 | 10 | 12 | | | | | H | 8 | 10 | 10 | 12 | | |
| | | L | 30 | 35 | 40 | 48 | | | | | L | 30 | 35 | 40 | 48 | | |
| | | M | 12 | 15 | 17 | 17 | | | | | M | 12 | 15 | 17 | 17 | | |
| Side | | Type of Shape | | | Size | | | Side | | Type of Shape | | | Size | | | | |
| <input type="checkbox"/> RH | | <input type="radio"/> palmar <input type="radio"/> elbow | | | | | | <input type="checkbox"/> RH | | <input type="radio"/> palmar <input type="radio"/> elbow | | | | | | | |
| <input type="checkbox"/> LH | | <input type="radio"/> palmar <input type="radio"/> elbow | | | | | | <input type="checkbox"/> LH | | <input type="radio"/> palmar <input type="radio"/> elbow | | | | | | | |

| Wooden Tray | | | | | |
|--|----------------------|--|----------------------------|----------------------------|----------------------------|
| <input type="checkbox"/> Ergonomic | with Hardware | <input type="checkbox"/> w/lateral flip <input type="checkbox"/> detachable | | | |
| <input type="checkbox"/> Rectangular | with Hardware | <input type="checkbox"/> w/lateral flip <input type="checkbox"/> detachable | | | |
| Padding | | <input type="checkbox"/> in black leatherette <input type="checkbox"/> in blue leatherette | | | |
| <input type="checkbox"/> Outer Edge | | | | | |
| ergonomic tray dimensions | | rectangular tray dimensions | | | |
|  | Size cm | <input type="checkbox"/> US | <input type="checkbox"/> P | <input type="checkbox"/> M | <input type="checkbox"/> G |
| | P | 47 | 53 | 58 | 66 |
| | L | 58 | 69 | 75 | 86 |
| | B | 35 | 42 | 49 | 55 |
| | A | 17 | 19 | 21 | 24 |
|  | Size cm | <input type="checkbox"/> US | <input type="checkbox"/> P | <input type="checkbox"/> M | <input type="checkbox"/> G |
| | P | 45 | 50 | 55 | 63 |
| | L | 56 | 66 | 71 | 82 |
| | B | 35 | 42 | 48 | 55 |
| | A | 17 | 19 | 21 | 24 |

| Pelvic Belt (w/2 adjustments Versa-Fixatis) (for other models please see Fixatis Range order form) | | | | | |
|--|-------------------------|-----------------------------|----------------------------|----------------------------|----------------------------|
|  | cm | <input type="checkbox"/> XS | <input type="checkbox"/> S | <input type="checkbox"/> M | <input type="checkbox"/> L |
| | H (<i>pad height</i>) | 4.5 | 5.5 | 7 | 7 |
| | L (<i>pad length</i>) | 12 | 17 | 22 | 27 |
| <input type="checkbox"/> Basket | | | | | |
| <input type="checkbox"/> Rain cover | | | | | |
| Foot Muff <input type="checkbox"/> Blue <input type="checkbox"/> Pink <input type="checkbox"/> Grey <input type="checkbox"/> Bordeaux | | | | | |
| Canopy adaptor included <input type="checkbox"/> Blue <input type="checkbox"/> Pink <input type="checkbox"/> Grey <input type="checkbox"/> Bordeaux Note: not available for size M1-L-XL | | | | | |

| FRAME DIMENSIONS AND FEATURES | | | | | | | | | | | | |
|---|--------------------|------------------------------------|---|---------|---------|---------|---------|----------|----------|----------|----------|---------|
| Load (kg)/ Frame Weight* (kg) | | US | XXS | XS | XS0 | XS1 | S | M | M1 | L | XL | |
| Rigid Frame | | 50/14.1 | 50/14.4 | 50/14.7 | 50/15.4 | 75/19.2 | 75/19.5 | 100/19.8 | 100/19.9 | 100/20.1 | 100/20.3 | |
| Folding Frame | | 50/14.9 | 50/15.3 | 50/15.6 | 50/15.9 | 75/19.5 | 75/19.9 | 75/20.2 | 75/20.3 | 75/20.5 | 75/20.8 | |
| * Weight of the frame, including knee angle and footplates as per standard configuration | | | | | | | | | | | | |
| Overall dimensions (cm) of the frame with backrest tubes (fixed) folded down, footrest and posterior wheels detached | | | | | | | | | | | | |
| Size | | US | XXS | XS | XS0 | XS1 | S | M | M1 | L | XL | |
| Length | | 66 | 66 | 68 | 68 | 71 | 73 | 83 | 83 | 73 | 83 | |
| Width | C | 30 | 30 | 30 | 30 | 30 | 32 | 32 | 32 | 32 | 32 | |
| | R | 42 | 48 | 48 | 51 | 51 | 54 | 54 | 57 | 54 | 60 | |
| Height | | 65 | 65 | 66 | 66 | 67 | 67 | 68 | 68 | 67 | 68 | |
| Weight (kg) | R | 11.4 | 11.7 | 12 | 12.7 | 12.9 | 13.1 | 13.5 | 13.6 | 13.8 | 14 | |
| | C | 12.2 | 12.6 | 12.9 | 13.2 | 13.3 | 13.6 | 13.9 | 14 | 14.2 | 14.5 | |
| Note: The length dimensions, referred to the average values, are subjected to the variations due to the displacement of the wheel plates. The values reported are intended for the standard configuration. | | | | | | | | | | | | |
| Width (cm) | | | | | | | | | | | | |
| | | | US | XXS | XS | XS0 | XS1 | S | M | M1 | L | XL |
| 300mm wheel | standard | | 48 | 53 | 53 | 56 | 56 | 59 | 59 | 62 | 65 | 65 |
| | w/drum brake | | 49 | 54 | 54 | 57 | 57 | 60 | 60 | 63 | 66 | 66 |
| 400/500mm wheel | standard | | 50 | 55 | 55 | 58 | 58 | 61 | 61 | 64 | 67 | 67 |
| | w/drum brake | | 53 | 58 | 58 | 61 | 61 | 64 | 64 | 67 | 70 | 70 |
| 600mm wheel | / | | / | 55 | 55 | 58 | 58 | 61 | 61 | 64 | 67 | 67 |
| Pivot Width (cm) | | | 69 | 69 | 72 | 75 | 75 | 75 | 78 | 78 | 75 | 78 |
| Q* (min-max) Height Seat rail to footplate (cm) | | | 13-23 | 13-23 | 13-26 | 13-26 | 28-36 | 28-36 | 32-40 | 32-40 | 28-36 | 32-40 |
| H** Seat rail to floor (cm) | | | 43-49 with 300/500mm wheels and 150/175mm castors 45 with 400mm wheels and 150/175mm castors 47 with 600mm wheels and 150mm castors | | | | | | | | | |
| Max Slope | | | 7° | | | | | | | | | |
| Note: *The value Q, referred to 90° footrest hanger, can be increased of about 5-7 cm by using the 75° hanger **The value H has been detected outside the seat tube at the plate of the tilt mechanism; the frame will be delivered with H=43 cm | | | | | | | | | | | | |
| Lenght (cm) | | | | | | | | | | | | |
| | | | US | XXS | XS | XS0 | XS1 | S | M | M1 | L | XL |
| 300mm wheel | Without Knee angle | L | 70 | 70 | 73 | 73 | 75 | 75 | 78 | 78 | 75 | 78 |
| | 75° Knee Angle | L _{min} /L _{max} | 92/99 | 92/99 | 93/100 | 93/100 | 97/104 | 97/104 | 100/107 | 100/107 | 97/104 | 100/107 |
| | 90° Knee Angle | L _{min} /L _{max} | 88/96 | 88/96 | 91/99 | 91/99 | 93/100 | 93/100 | 96/103 | 96/103 | 93/100 | 96/103 |
| 400mm wheel | Without Knee angle | L | 74 | 74 | 77 | 77 | 79 | 79 | 82 | 82 | 79 | 82 |
| | 75° Knee Angle | L _{min} /L _{max} | 95/101 | 95/101 | 96/103 | 96/103 | 100/107 | 100/107 | 103/110 | 103/110 | 100/107 | 103/110 |
| | 90° Knee Angle | L _{min} /L _{max} | 93/99 | 93/99 | 94/100 | 94/100 | 96/102 | 96/102 | 99/104 | 99/104 | 96/102 | 99/104 |
| 500mm wheel | Without Knee angle | L | 78 | 78 | 81 | 81 | 84 | 84 | 87 | 87 | 84 | 87 |
| | 75° Knee Angle | L _{min} /L _{max} | 98/103 | 98/103 | 99/107 | 99/107 | 103/113 | 103/113 | 106/116 | 106/116 | 103/113 | 106/116 |
| | 90° Knee Angle | L _{min} /L _{max} | 95/101 | 95/101 | 97/102 | 97/102 | 100/106 | 100/106 | 103/109 | 103/109 | 100/106 | 103/109 |
| 600mm wheel | Without Knee angle | L | / | 83 | 84 | 84 | 85 | 85 | 88 | 88 | 85 | 88 |
| | 75° Knee Angle | L _{min} /L _{max} | / | 101/109 | 103/112 | 103/112 | 108/116 | 108/116 | 111/120 | 111/120 | 108/116 | 111/120 |
| | 90° Knee Angle | L _{min} /L _{max} | / | 98/104 | 101/107 | 101/107 | 105/112 | 105/112 | 108/116 | 108/116 | 105/112 | 108/116 |
| L = Length of the frame without knee angle joint mechanism; L _{min} = Length of the frame with knee angle joint mechanism and footplate positioned backward; L _{max} = Length of the frame with knee angle joint mechanism and footplate positioned forward Note: The length dimensions, referred to the average values, are subjected to variations due to the displacement of the wheel plates. The values reported are intended for the standard configuration. | | | | | | | | | | | | |

Note



PRO MEDICARE S.r.l.
Via Montagna Z.I. Lotto 41-72023 Mesagne (Br)-ITALY
Tel: +39-0831-777840
Website: www.promedicare.eu e-mail: sales@promedicare.it